

# GPS Electric Cars Positioning Terminal

## User Manual

**V1.0**



## Introducing your Device

Learn about your device' s layout, indications and specifications.

### 1. Inside the Box

Check your product box for the following items:

- Device
- Charging cable
- Relay
- User Manual

### 2. Overview



#### LED Indicators

| Power indicator (red)                           | Indication  |
|---|-------------|
| Quick Flashing (flash 0.3s at interval of 0.3s) | Low battery |
| Solid red                                       | Charging    |
| Flashing (flash 1s at interval of 3s)           | Full charge |

|  |                          |
|--|--------------------------|
| Off  | Power off or low battery |
| Slow flashing (flash 0.1s at interval of 3s) | Working normally         |

| <b>GPS indicator (blue)</b>                  | <b>Indication</b>           |
|--|-----------------------------|
| Flashing (flash 1s at interval of 3s)        | Searching GPS signal        |
| Slow flashing (flash 0.1s at interval of 3s) | Receive GPS signal normally |
| OFF  | No GPS signal               |

| <b>GSM indicator (green)</b>                    | <b>Indication</b>            |
|---|------------------------------|
| Quick Flashing (flash 0.3s at interval of 0.3s) | GSM initializing             |
| Flashing (flash 1s at interval of 3s)           | Receive GSM signal normally  |
| Solid green                                     | In communication with phones |
| OFF   | No GSM signal or no SIM card |
| Slow flashing (flash 0.1s at interval of 3s)    | GPRS on line                 |

### 3. Specifications

|                       |                                |
|-----------------------|--------------------------------|
| Dimension             | 78.0(L) x 41.0(W) x 13.0(H) mm |
| Weight                | 38g                            |
| Voltage range         | 7.5-90V                        |
| Backup Battery        | 270mAh / 3.7V                  |
| Operation Temperature | -20°C-70°C                     |
| Humidity              | 20% - 80%                      |
| Standby Time          | 50 hours                       |
| GSM Frequencies       | 850/900/1800/1900 MHz          |
| GPRS                  | Class 12, TCP/IP               |
| GPS Channel           | 66                             |

|                           |  |
|---------------------------|--|
| GPS Sensitivity           | -165dBm  |
| Acquisition Sensitivity   | -148dBm  |
| Position Accuracy         | <10m   |
| TTF ( Open Sky )          | Cold Start: < 45s                                    |
|                           | Hot Start : < 2s                                     |
| GSM/GPS Antenna           | Built-in design                                      |
| LED Indicator             | GSM-green, GPS-blue, Power-red                       |
| Data Transmit             | TCP, SMS   |
| Geo-fence Alarm           | Alarm when get in or get out a specified area        |
| Speeding Alarm            | Report when speeds higher than the pre-set value.    |
| Low Power Alarm           | Alarm when backup battery is running out             |
| Non-movement<br>Detection | Movement alarm based on built-in 3D motion<br>sensor |
| Mileage Report            | Track by time/distance interval                      |
| Remote Control            | Cut off petrol/electricity                           |

## 4. Getting Started

### 4.1 Switch on

Get started by assembling and setting up your device for its first use.

1. Open the SIM card cover.

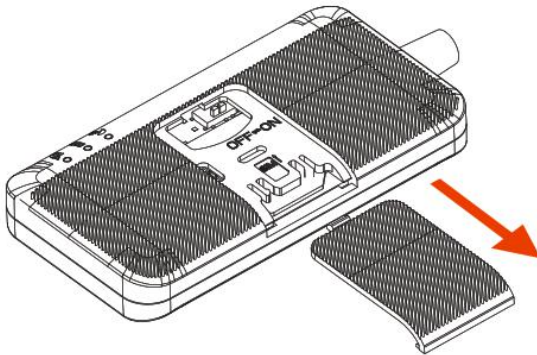

2. Insert the SIM card.

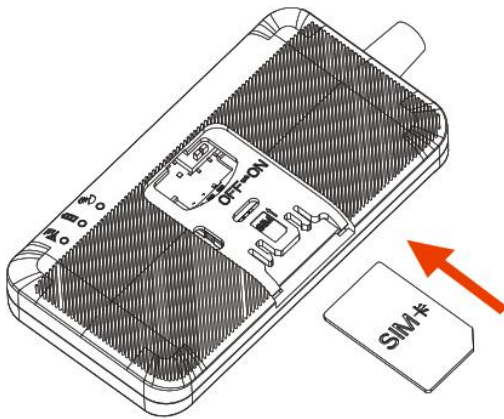

Note: SIM card should be equipped with GPRS and SMS functions.

3. Turn power on.

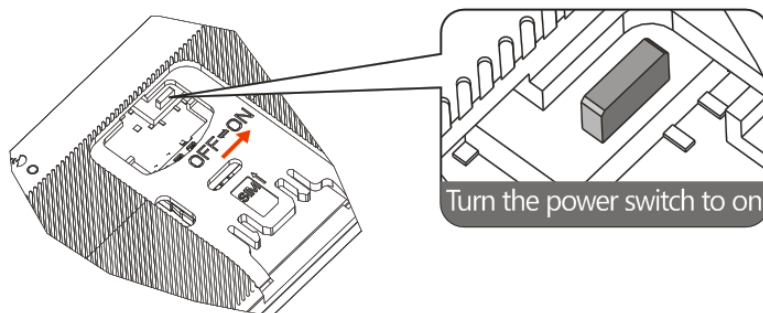

4. Close the SIM card cover and connect the device with the external power line which will be used to charge the terminal and built-in battery.

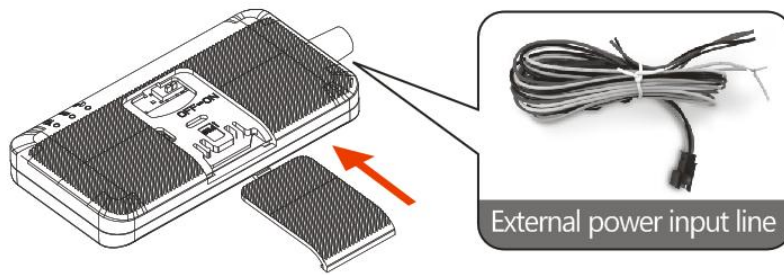

## 4.2 Switch off

1. Take the SIM card out and turn power off.

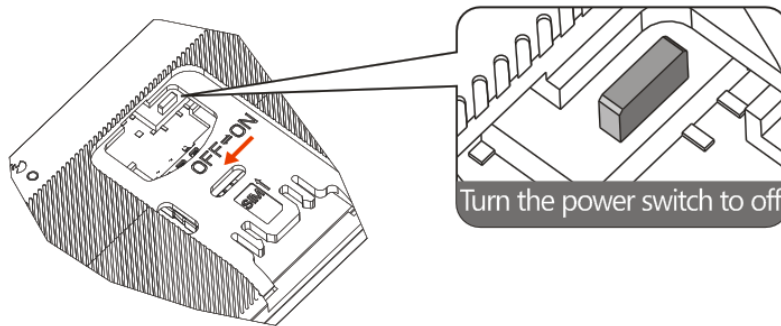

2. Close the SIM card cover and cut external power off.

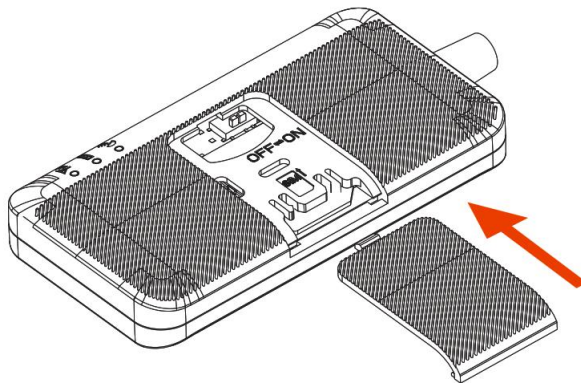

## 4.3 Charge the device (Covert installation)

Plug the device connector into a charging cable.

The charging cable with 2A FUSE for short-circuit over current protection.

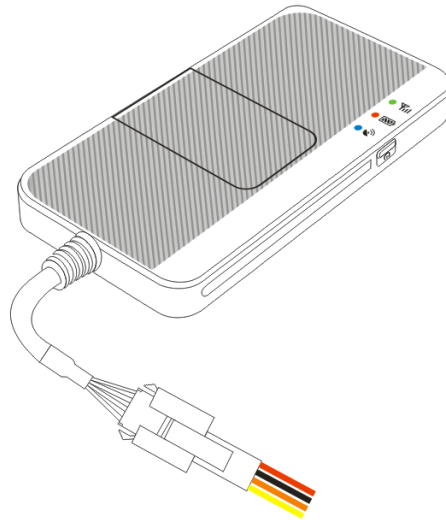

Note : Improperly connecting the charging cable can cause serious damage to the device. Any damages by misuse are not covered by the warranty.

#### **4.4 Install the device**

You need to choose somewhere that it won't be found, because the whole point of fitting covert GPS vehicle tracker is the secrecy element.

1. Your device has built-in GSM antenna and GPS antenna. During installation, please make sure the receiving side face is up ; any high power devices such as reversing radar, anti-theft device or communication equipment would affect the signal of the device.
2. All metallic cases of the windshield will attenuate the signal on the tracking device. It' s simply due to the shielding effects of the metal compound of the case.
3. The device should be fixed into position with cable ties or wide double-side tape.

Installation please refers to below picture.

## 1. Best place to install

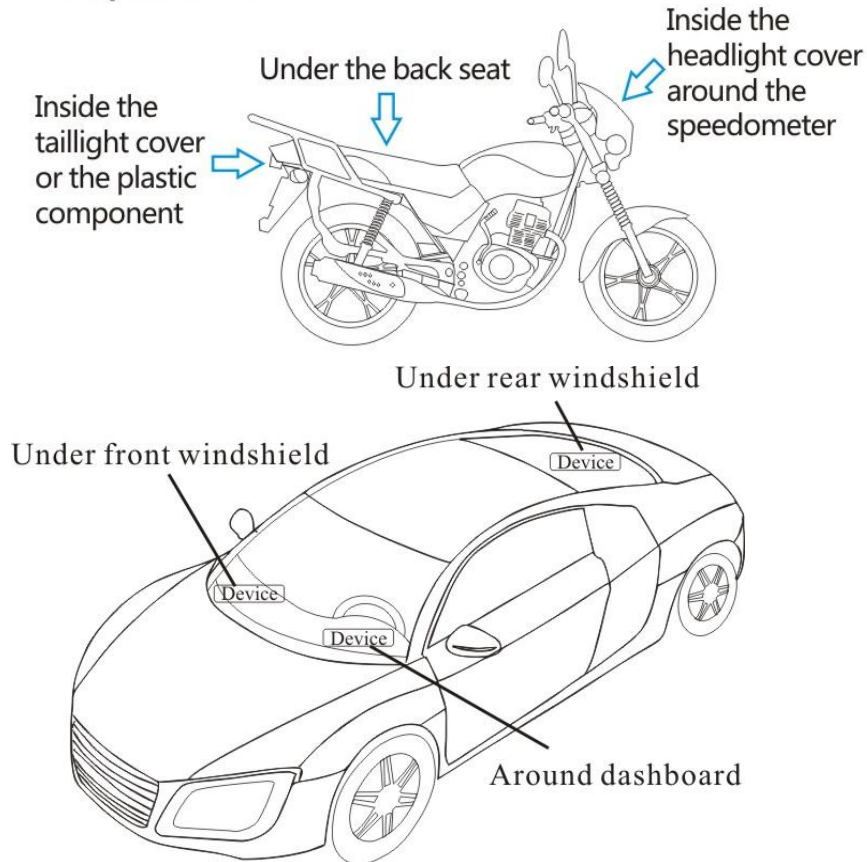

- Under the dash board below the front windshield;
- In the parcel shelf in the rear;
- In the front bumper (non-material face), make sure the device does not get wet;
- Under the wiper version (non-metal), make sure the device does not get wet;
- Non Covert Installation - fix the device on the dash board below windshield.

## Device Wiring

---

- 1 The standard voltage is 9V-36V, the red wire is the positive, the black wire is the negative.
2. Connect the black wire to ground.

## 4.5 Device wiring diagram



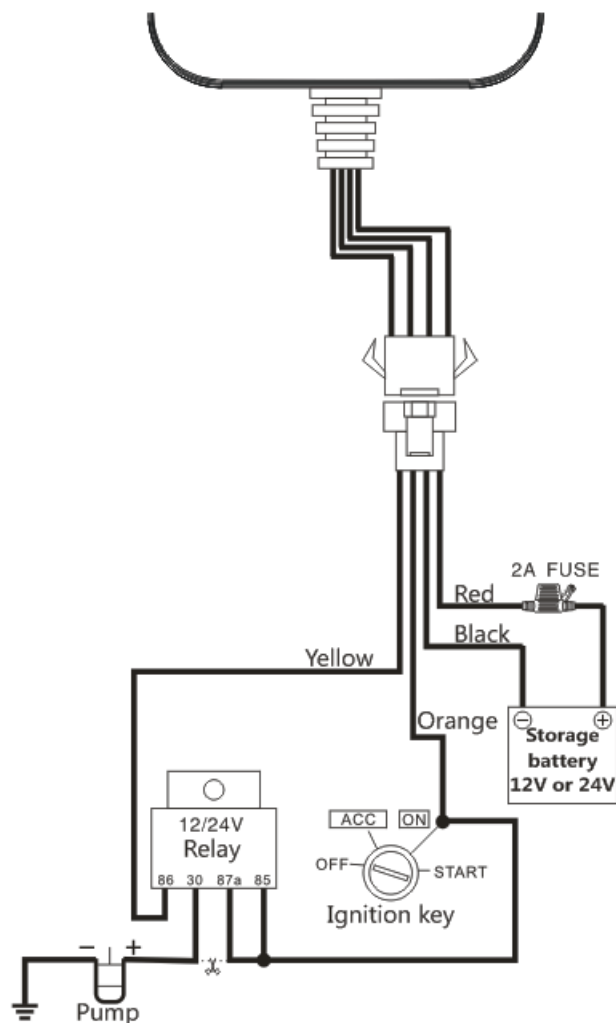

NOTE: Please pay attention to the diagram description, battery is 7.5-90V and relay remains 12V / 24V.

#### 4.6 Power/ACC/Tele-cutoff(petrol/electricity) control line (4 pin)

1. Your device comes with a power cord and is designed to use only manufacturer-specified original device. The red line is positive while the black one is negative (the side should not be connected with ground wire).

2. The ACC line (orange) connects to ACC switch of the vehicle. Please be sure to connect the ACC line; otherwise the device will enter ignition detection status when disconnect the ACC line. If you don't need to anti-theft temporarily, just connect the ACC line to the positive side in parallel.

3. Tele-cutoff (petrol/ electricity) control line (yellow) is connected to pin 86 of the Tele-cutoff (petrol/ electricity) relay (equal to the yellow line of the relay socket).

## **5. Quick Operation Instructions**

To properly use the device, common parameters should be set before initial use. This can be done by using the parameter editor or by sending SMS commands to the device. ( ", " should be English comma and no space before and after the comma)

### **5.1 Add SOS number**

SMS command to the device to add the SOS number.

**SOS,A,No.1,No.2,No.3#**

"A" means to add new numbers, for example:

**SOS,A,18165542975,18165542976,18165542977#**

It will reply

"OK!"

SOS1: 18165542975 SOS2: 18165542976 SOS3: 18165542977"

after set successfully.

## 5.2 APN setting

To connect default platform [www.cootrack.net](http://www.cootrack.net), please send the SMS command

below , APN command format:

**APN,APN name#** or **APN,APN name,user name,password#**

Example:

**APN,CLENTE#** or **APN,ORANGE,ORANGE,ORANGE#**

An automatic reply "OK" will be sent in one minute if setup is successful.

## 5.3 Server setting

To connect other platform, please send the SMS commands below:

Command format :

**SERVER,1,domain,Port,0#**

Example:

**SERVER,1,www.cooaccess.net,8841,0#**

It will reply "OK" after set successfully.

## 5.4 Set the center number

If you want to cut off/restore oil by SMS command, you have to set a center number firstly. Only the center number can send the cut off/restore oil command to the device. You can set your own mobile number as center number.

The command for setting center number is:

**CENTER,A,mobile number#**

For example:

**CENTER,A,18165542976#**

If set successfully, there is an "OK" reply message.

Only the SOS number can be used to add or delete center number successfully.

There is only one center number can be set.

### **5.5 GPRS time interval**

Users can modify GPRS time sending interval by SMS

**TIMER,T1,T2#**

T1 ranges 5~18000 or 0(seconds), upload interval when ACC ON, 0 means no upload, default is 10;

T2 ranges 5~18000 or 0(seconds), upload interval when ACC OFF, 0 means no upload, default is 10;

### **5.6 Vibration alarm delay time setting**

Delay time for device entering vibration alarm state after the vehicle power is off and ACC is in low-level. In the vibration alarm state, if the vehicle vibrates for a few times, it will activate the vibration alarm system. If the vehicle battery is still not on (ACC is in low level) after 3 minutes, the device will start vibration alarm.

SMS format:

**DEFENSE,TIME#**

The time ranges from 1 to 60 minutes, default is 10.

Note:

1. Preset SOS numbers before sending SMS alarm messages and calls.
2. If there is no need for vibration alarm, please SMS **SENALM,OFF#** to close it.

### 5.7 Check parameter setting

You can check the parameter setting by command:

**PARAM#**

Example: **PARAM#**

Information replied:

IMEI: 353419032348877 ---IMEI number of the device;

TIMER: 10,10; ---GPS data uploading Interval;

SENDS:5; --- the GPS working time when ACC is OFF;

SOS:18165542976,,; --- SOS numbers, maximum 3 SOS numbers can be set and used for alarm and monitoring;

Center Number:18165542976; ---only 1 center number can be set and used for cutting off /restoring oil command;

Sensoralm: 10,5,1,180; --- detect 5 vibrations in 10s; the alarm delay is 180s;

Defense time: 10; --- the vibration alarm delay is 10 minutes;

TimeZone:E,8,0; --- time zone info.

The replied information contains IMEI number, GPS data uploading Interval, GPS working time, SOS number, center number, sensor time interval, vibration alarm delay and time zone info.

### 5.8 Check GPRS parameters



SMS command format :

**GPRSSET#**

Example : **GPRSSET#**

Reply message :

GPRS:ON //GPRS on/off status//

Currently use APN:CMNET,user,password; //APN setting information//

**SERVER,1,www.cooaccess.net,8841,0#** //platform information//

URL:http://maps.google.com/maps?q=; //preset web link setting information //

## 6. Operation of device

### 6.1 Power on/ Power off

Power on: Once insert a valid SIM card and connect all the wires, turn on the device, then Power LED will flash first, during signal searching process, GSM and GPS LED will flash. Once GPS LED keeps slow flashing, it means the device has been located and it starts to work.

Power off: Just turn off the power switch.

The device will begin to upload positioning data to server once inserting a valid SIM card and power on. During the working time, it can upload data to server every 10 seconds.

Note:

To power on / power off, please remove the back cover first, refer to **4. Getting Started**.

## 6.2 Check location

### 1. Via SMS

1.1 SMS **"WHERE#"** to the SIM number of device. The device will send a location message automatically. You can get the coordinates. If the device does not search any information of location, it will send "No data" to the cell phone.

Example:

Current position!

Lat:N22.577156,Lon:E113.916748,Course:131.99,Speed:0.00Km/h,Date

Time:2013-10-08 17:35:32

1.2 SMS **"URL#"** to the SIM number of device. The device will send a location Google Map link. If the device does not search any information of location, it will send "No data" to the cell phone.

Example:

<10-08 17:36><http://maps.google.com/maps?q=N22.577156,E113.916748>

### 2. Via platform

Go to the platform website offered by dealers to check your vehicle location.

## 6.3 Wire cut-off alarm

When the electricity supply of device is cut off, it will activate cut-off alarm. In this case, the device will send related SMS to the specific numbers and dial the numbers in circles. If nobody answers, the call just keeps 3 loops at most. At the meantime, the device will upload SOS alarm data to the server. And it will send:

Cut Power ! <Date Time:13-06-17 14 : 53 : 06> ,

<http://maps.google.com/maps?q=N22576713,E113.916585>

Note: The specific numbers should be preset, please refer to **5.1**

#### **6.4 Low battery alarm**

When the device is only working with battery, once the internal voltage of battery is less than 3.7V, device will send low battery alarm SMS to specific number and alarm on platform.

Low battery alarm SMS content example: "Attention!!!Battery is too low, please charge." Which means the battery is too low, inform user charging it in time.

Note: The specific numbers should be preset, please refer to **5.1**.

#### **6.5 Vibration alarm**

The vibration alarm function is off by default. To activate this function, please send the following command:

**SENALM, ON#**

The alarm will be sent to both the service platform and SOS numbers.

When vehicle power is off, ACC status is low, and if the lead time of low ACC is more than 10 minutes ( settable ) , device will activate security alarm. When the security alarm is on, once the vehicle vibrates for several times, the alarm will be activated; in the next 3 minutes, if vehicle power is still off( ACC status is low ) , device will start alarm. At this time, it will send alarm message to the service platform with the latitude and longitude, while the platform will reply the Chinese address. Then the



terminal will send vibration alarm message to SOS numbers with the Chinese address, and call the SOS numbers in cycle. If nobody answers, it will stop calling after 3 loops.

If the Chinese address can not be acquired for certain reason, the terminal will send a message with the website link to the SOS numbers.

Example:

Sensor Alarm ! <11-23 14:53> ,

<http://maps.google.com/maps?q=N22576713,E113.916585>

Note:

1. The SOS numbers should be preset.
2. Send "SENALM, OFF#" to turn off the vibration alarm if don' t need.

## **6.6 Oil cut-off**

### **1. via platform**

Send oil cut-off command on platform. To make sure the security of vehicle, tracker can only indicate to cut off oil when GPS is in valid position status, and the speed is less than 20KM/H or in static. Platform account password is needed when sending oil cut off command.

### **2. Via SMS**

Firstly, you should set a center number. Please refer to **5.4**.

Only center number can send the command to the device to cut off and restore oil.

The format is: **RELAY,1#**

After the command is carried out, it will reply "Cut off the fuel supply: Success! Speed:0 Km/h" . If the command didn't carry out, it will reply the reason about fail to carry out.

Note: To ensure the safety of the driver and the car, this command is valid only under two conditions: the GPS is located; the speed is less than 20km/h

## **6.7 Restoring Oil**

### **1. Via platform**

When the alarm is off, sending recover oil commands manually. Device will restore oil supplying, and vehicle will work normally again.

Platform account password is needed when sending oil cut off command.

### **2. Via SMS**

Only center number can send the command to the device to restore oil.

The format is: **RELAY,0#**

After the command is carried out, it will receive "Restore fuel supply: Success!"

## **6.8 Over Speed Alarm**

When the car is moving over a limited speed in average in a limited time period, then the device will send over speed alarm SMS to user.

To turn on the over speed function, please send below SMS command:

**SPEED,ON,Time,Limited speed,way of alarm#**

Time range ( Second ) : 5-600s (default as 20s).

Limited speed range ( km/h ) : 1-255, default : 120.

Way of alarm: 0, GPRS only; 1, SMS+GPRS; default : 1.

Example: **SPEED,ON,10,120,1#**

Means when the car is moving over 120km/h in average in 10 seconds, the device will send over speed alarm to user.

### 6.9 Restore to factory setting

SMS command format: **"FACTORY#"** to set all parameter to default factory value.

Once received "OK" , it succeeds.

### 6.10 Reboot device

When there is something wrong with the link of GPRS, e.g., the parameter setting of the device is correct, but you can't track the car on the platform. At this moment you can send a command to the device to reboot the device.

The format is: **RESET#**

After receiving this command, the device will reboot after 1mins.

## 7. Register and log onto GPS tracking platform: [www.cootrack.net](http://www.cootrack.net)

Account: IMEI Number

The function on the GPS platform can be realized as follows:

- Real-time Tracking
- Report and Statistics
- Online Configuration

## 8. Troubleshooting

If you are having trouble with your device, try these troubleshooting procedures before contacting a service professional.

| Problems     | Causes         | Solutions        |
|--------------|----------------|------------------|
| Red LED does | The fuse blows | Replace the fuse |

|                               |                                     |  |
|-------------------------------|-------------------------------------|--|
| not work when power connected |                                     |  |
| Fail to connect network       | Wrong installation of SIM card      | Check SIM card installation<br>(▶ 4.1 Install SIM card)    |
|                               | Filth on the SIM card iron surface. | Clean it   |
|                               | Useless SIM                         | Contact internet service provider                          |
|                               | Improper installation               | Check installation of device<br>(▶ 4.3 Install the device) |
|                               | Beyond GSM service area             | Use it in effective GSM service offer area                 |
|                               | Bad signal                          | Try again in a better signal area                          |
| Fail to charge                | The voltage is unsuitable           | Connect with power with suitable voltage                   |
|                               | Improper connection                 | Check connection with charger                              |

**ShenZhen Concox Information Technology CO.,Ltd**

Tel: +86 755 2912 1200

Fax: +86 755 2912 1290

E-mail: jason@concox.cn

Add: 4/F, Building B, Gaoxinqi Industrial Park,  
Liuxian 1st Road, No.67 Bao'an District, Shenzhen

www.iconcox.com